

VISTA 1

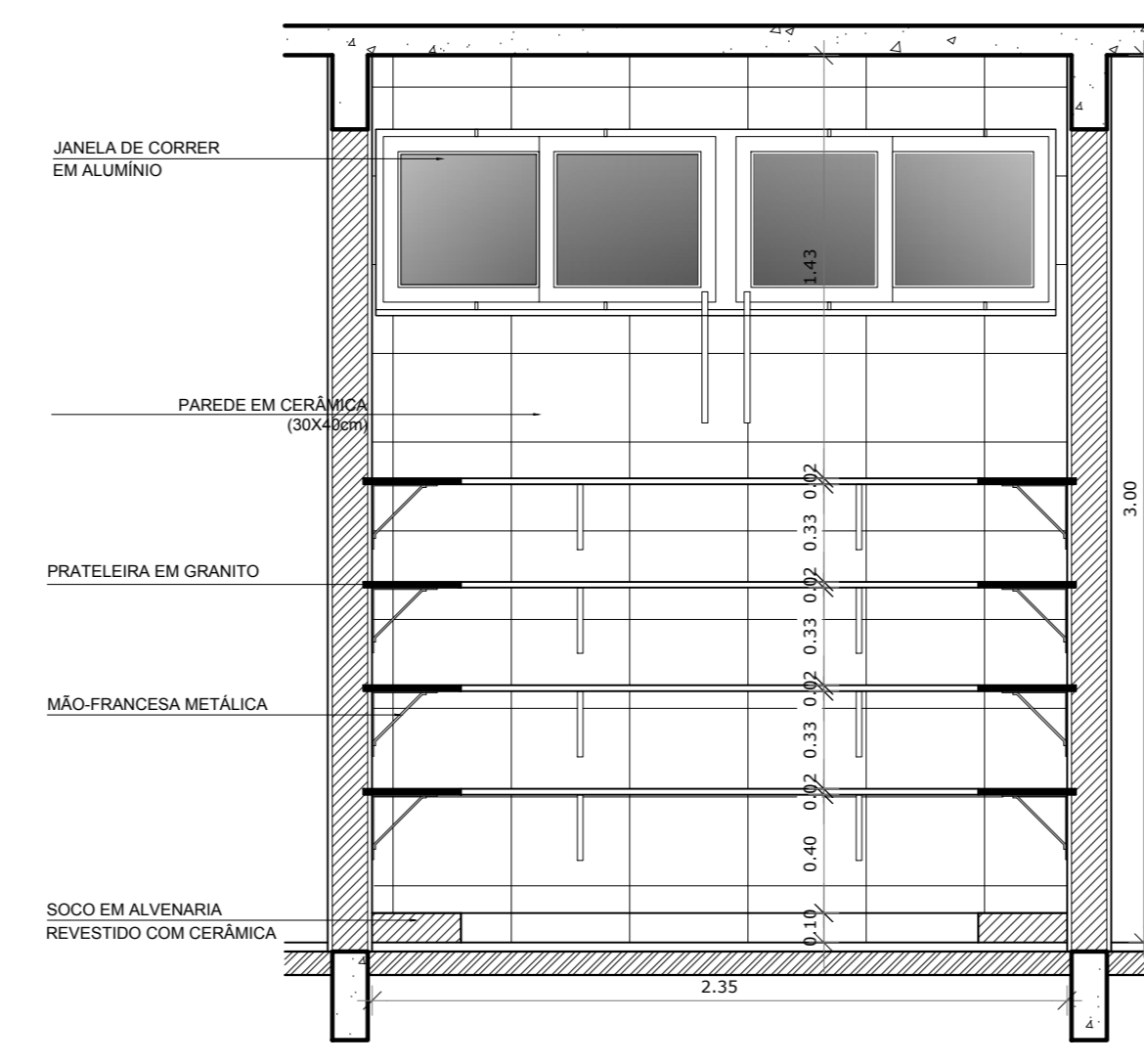

VISTA 2

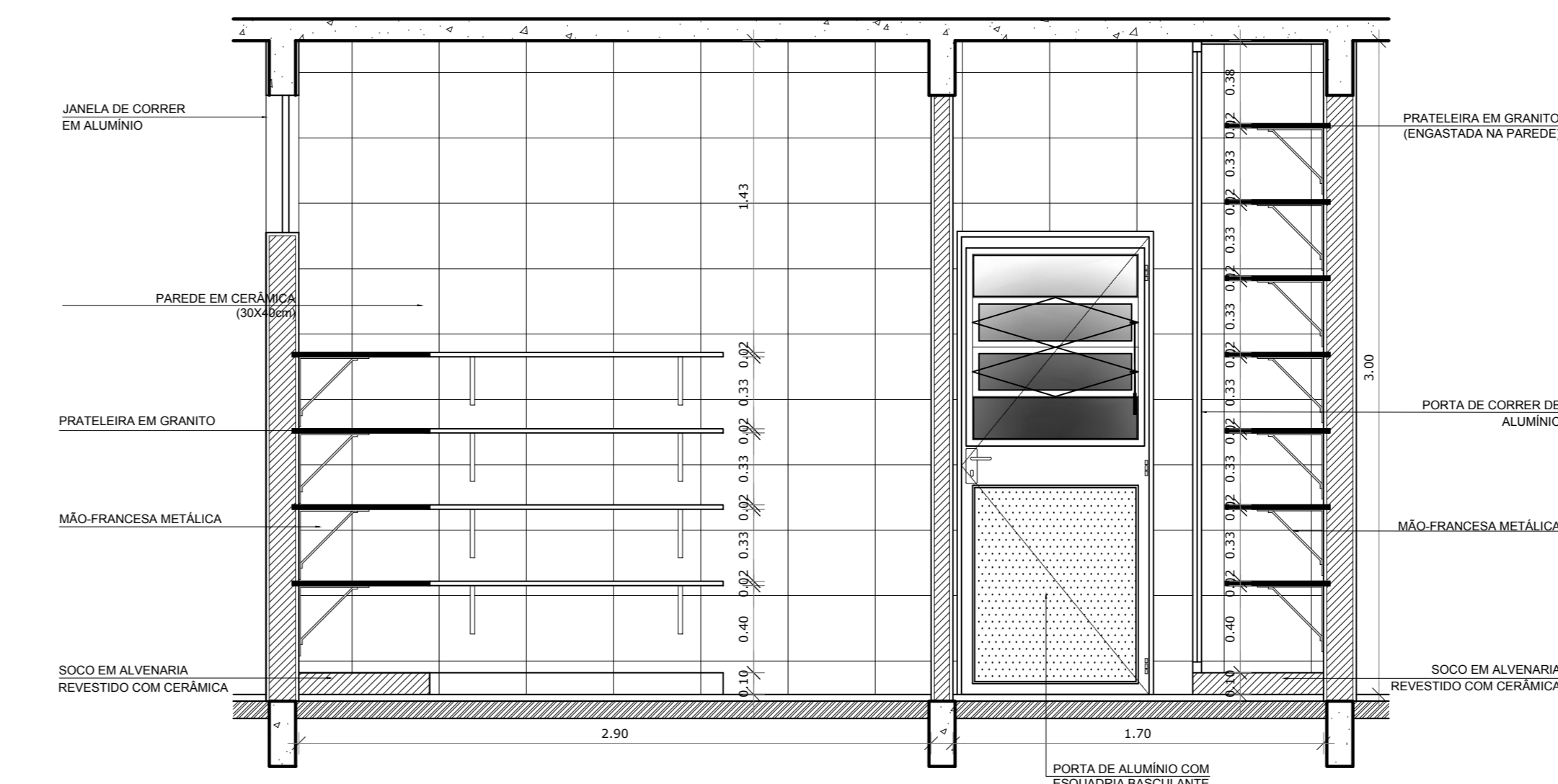

VISTA 3

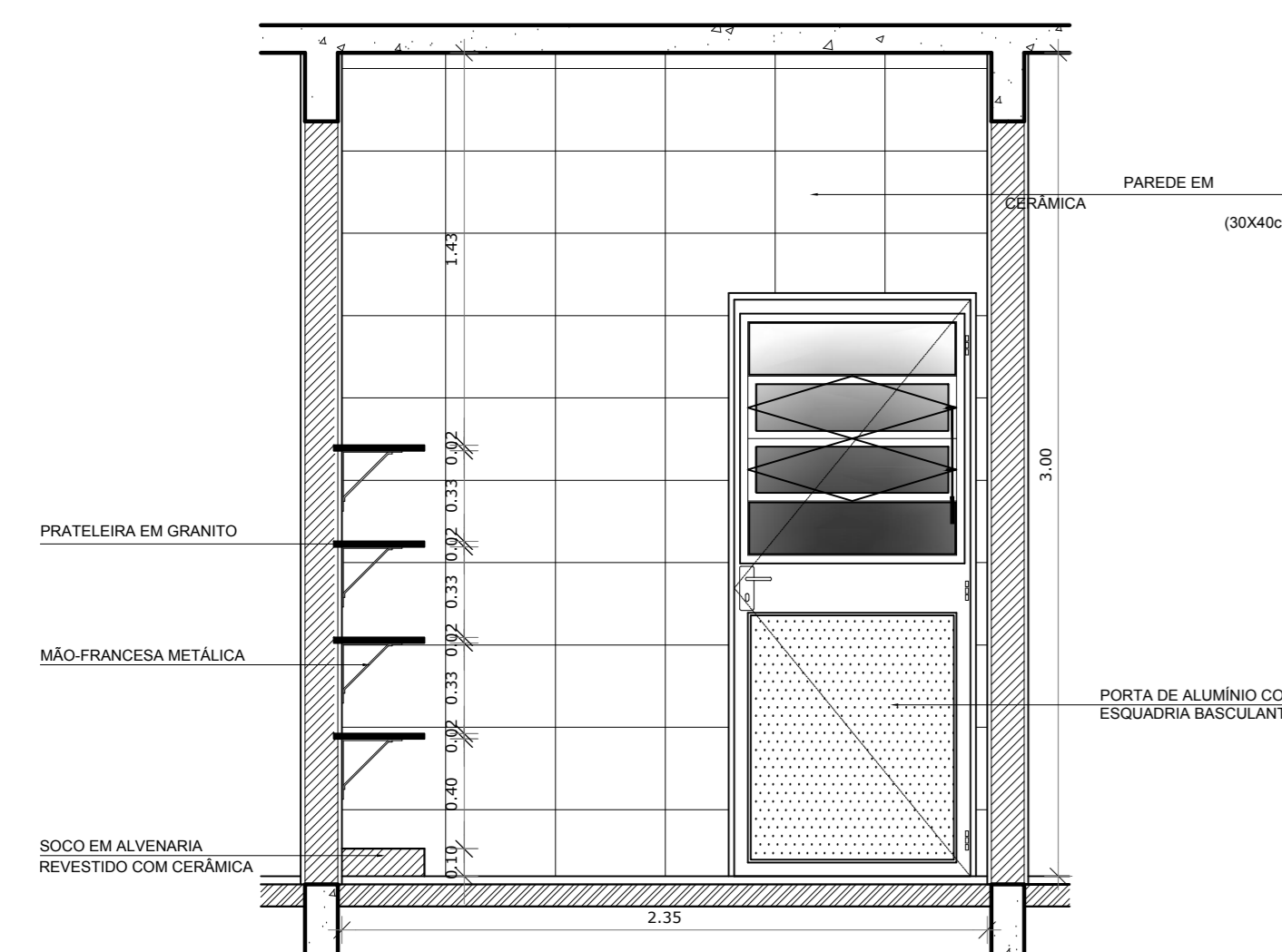

VISTA 4

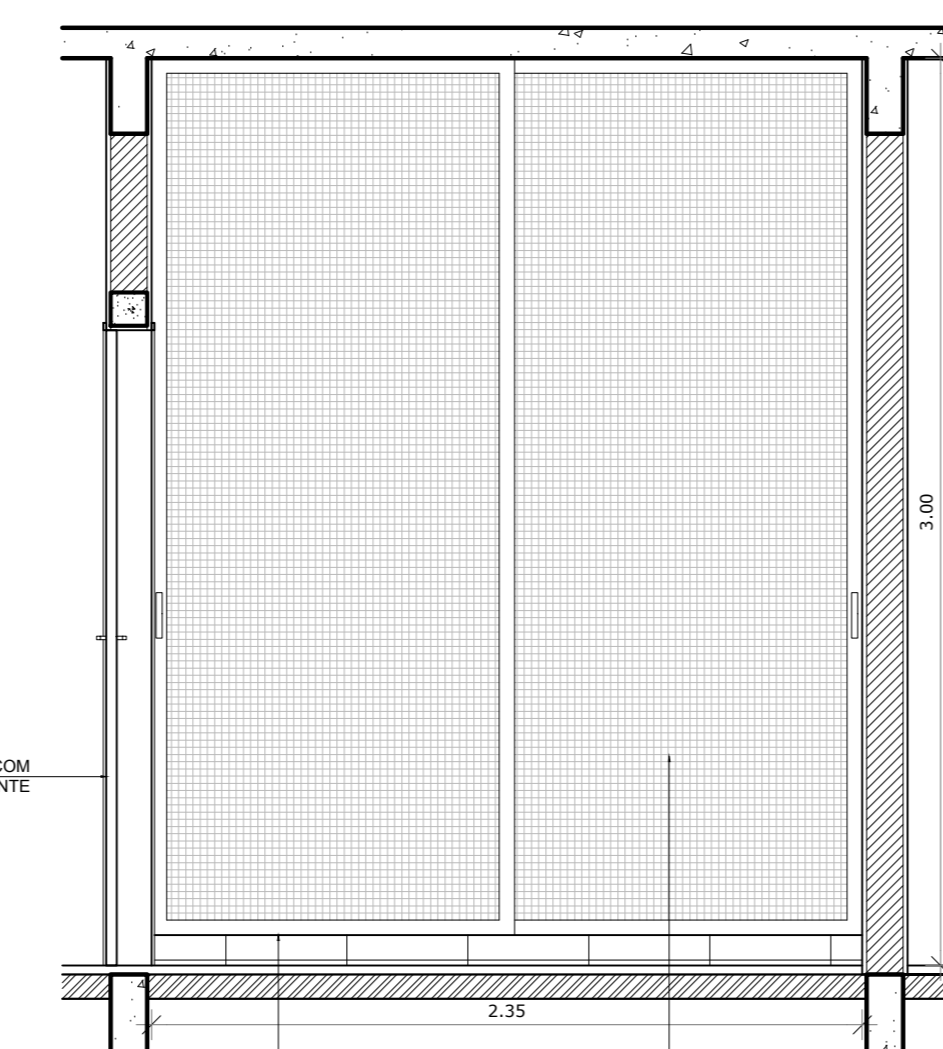

VISTA 5

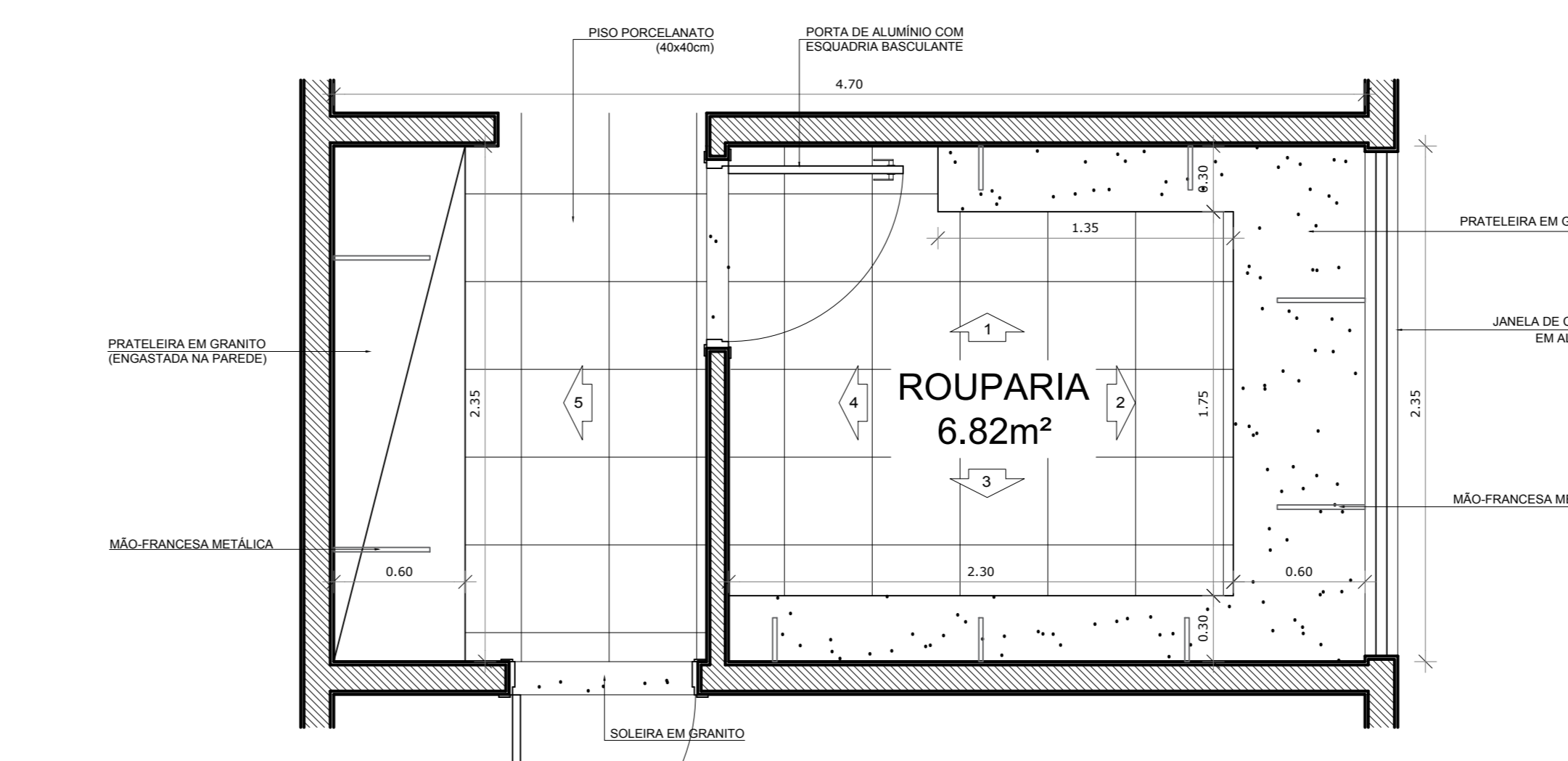

PLANTA BAIXA

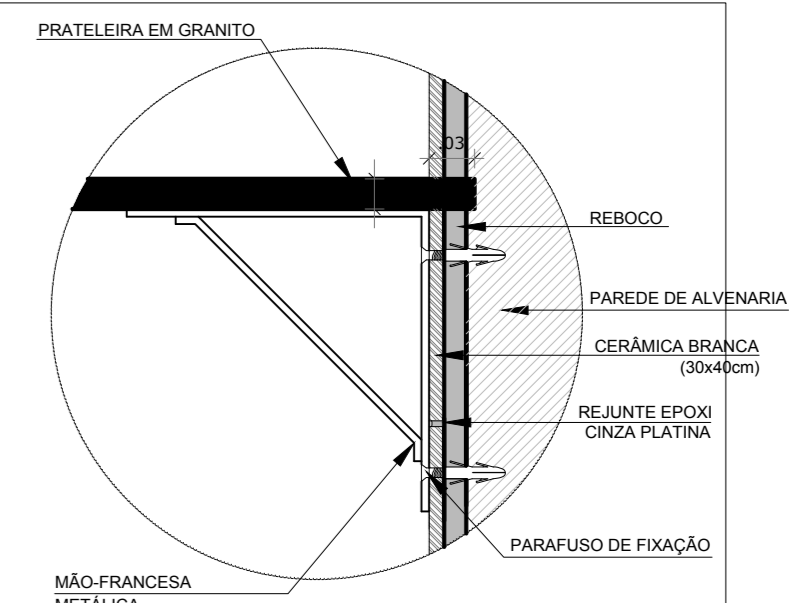

DETALHE PRATELEIRA DE GRANITO  
ESC.: 1/5

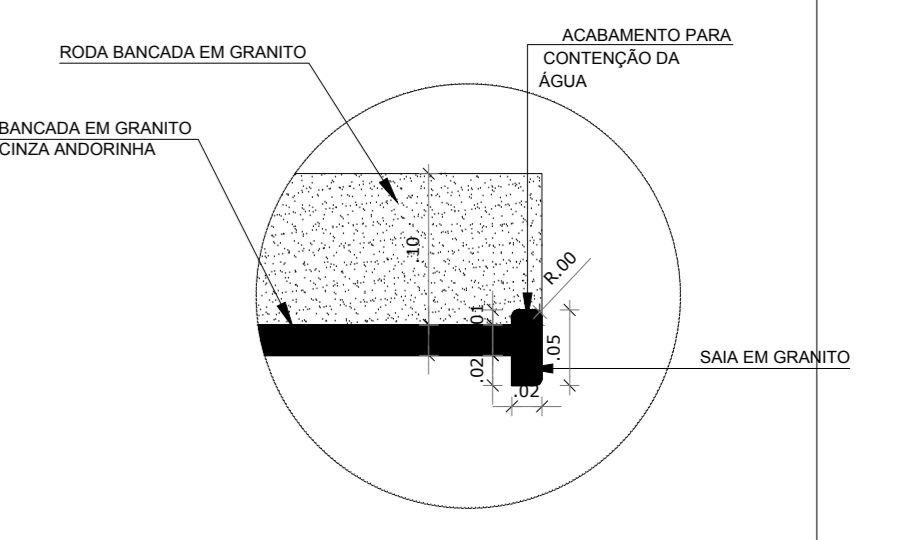

DETALHE BANCADA DE GRANITO -  
ÁREA MOLHADA  
ESC.: 1/5

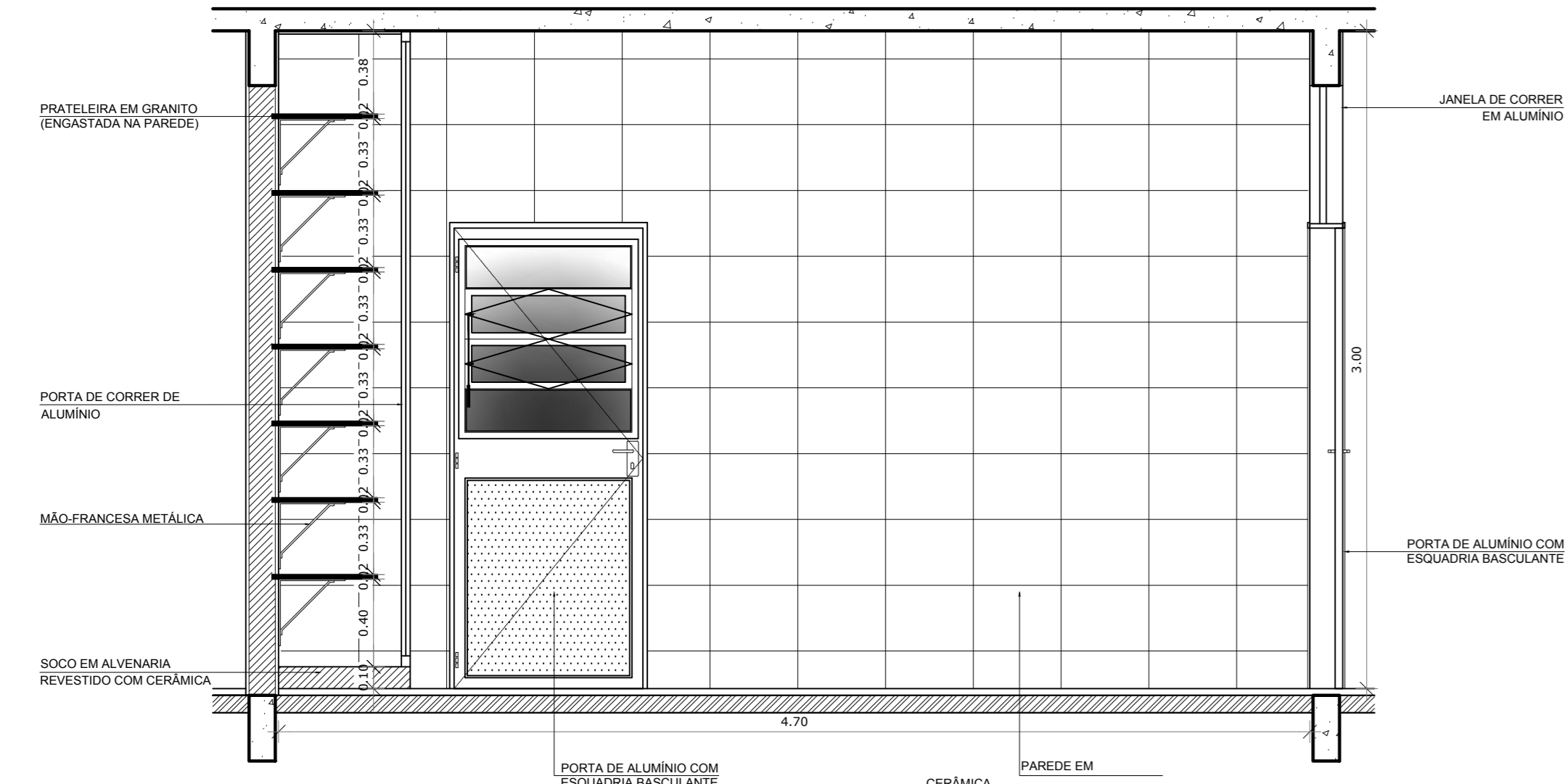

VISTA 1

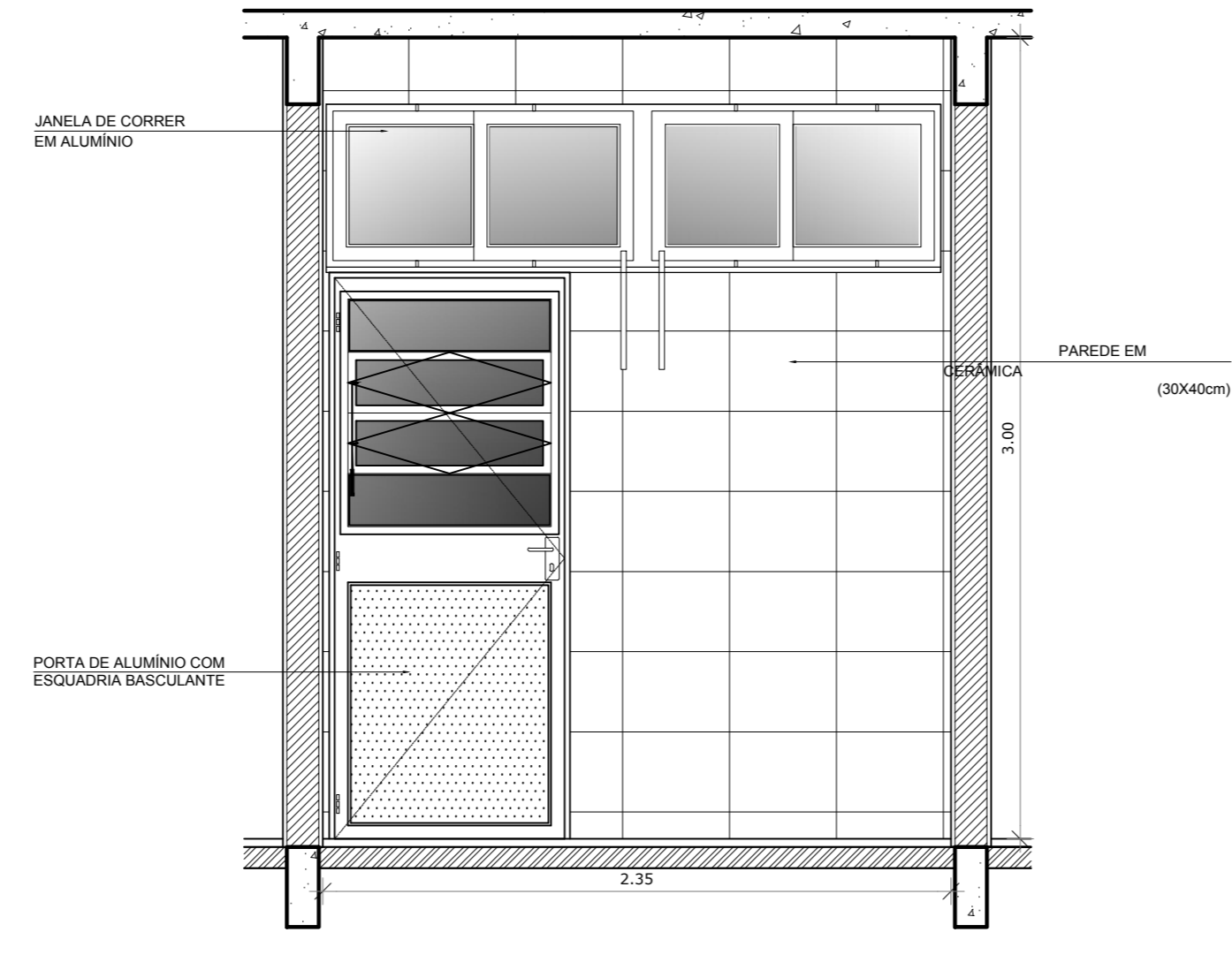

VISTA 2

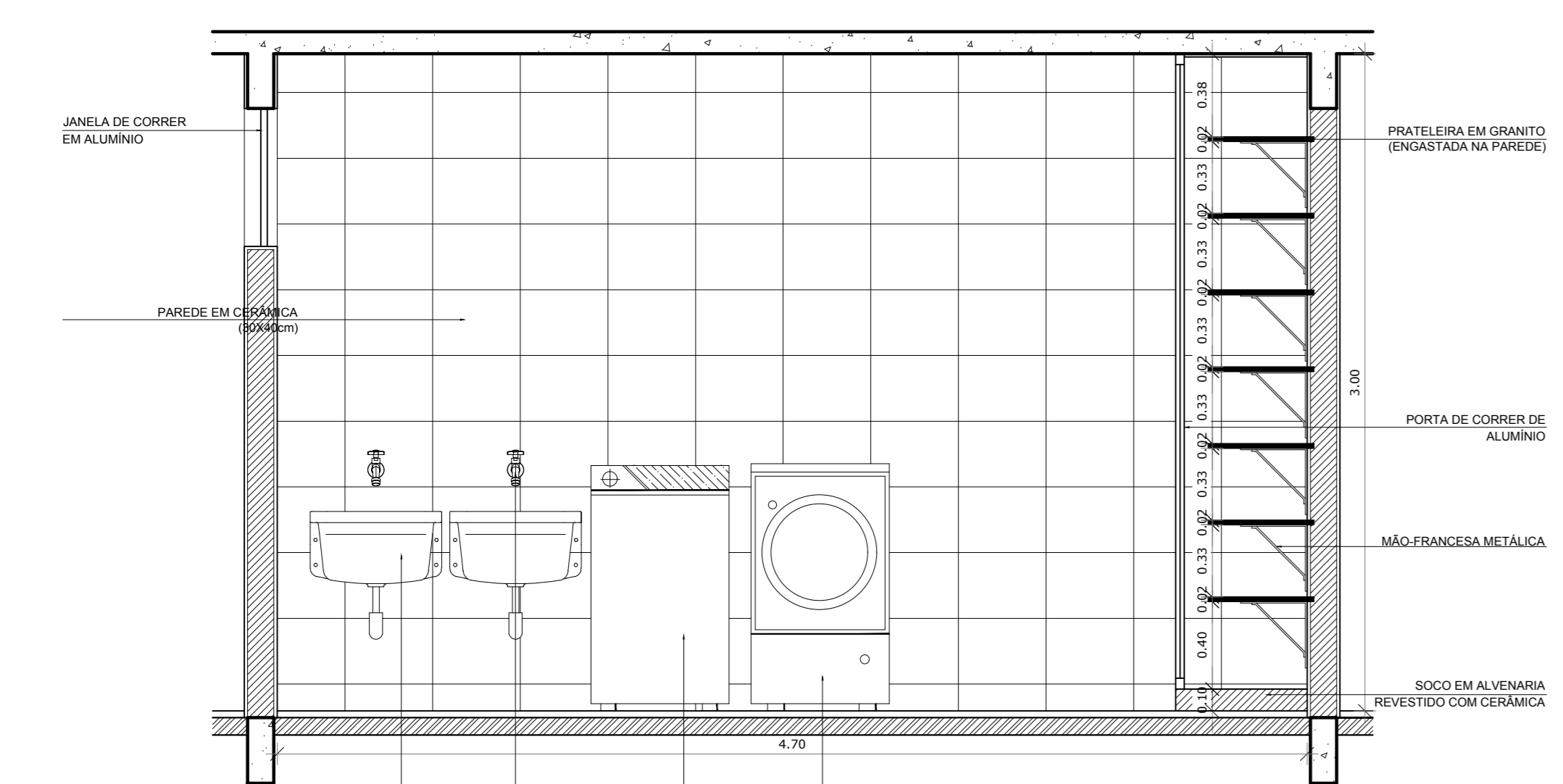

VISTA 3

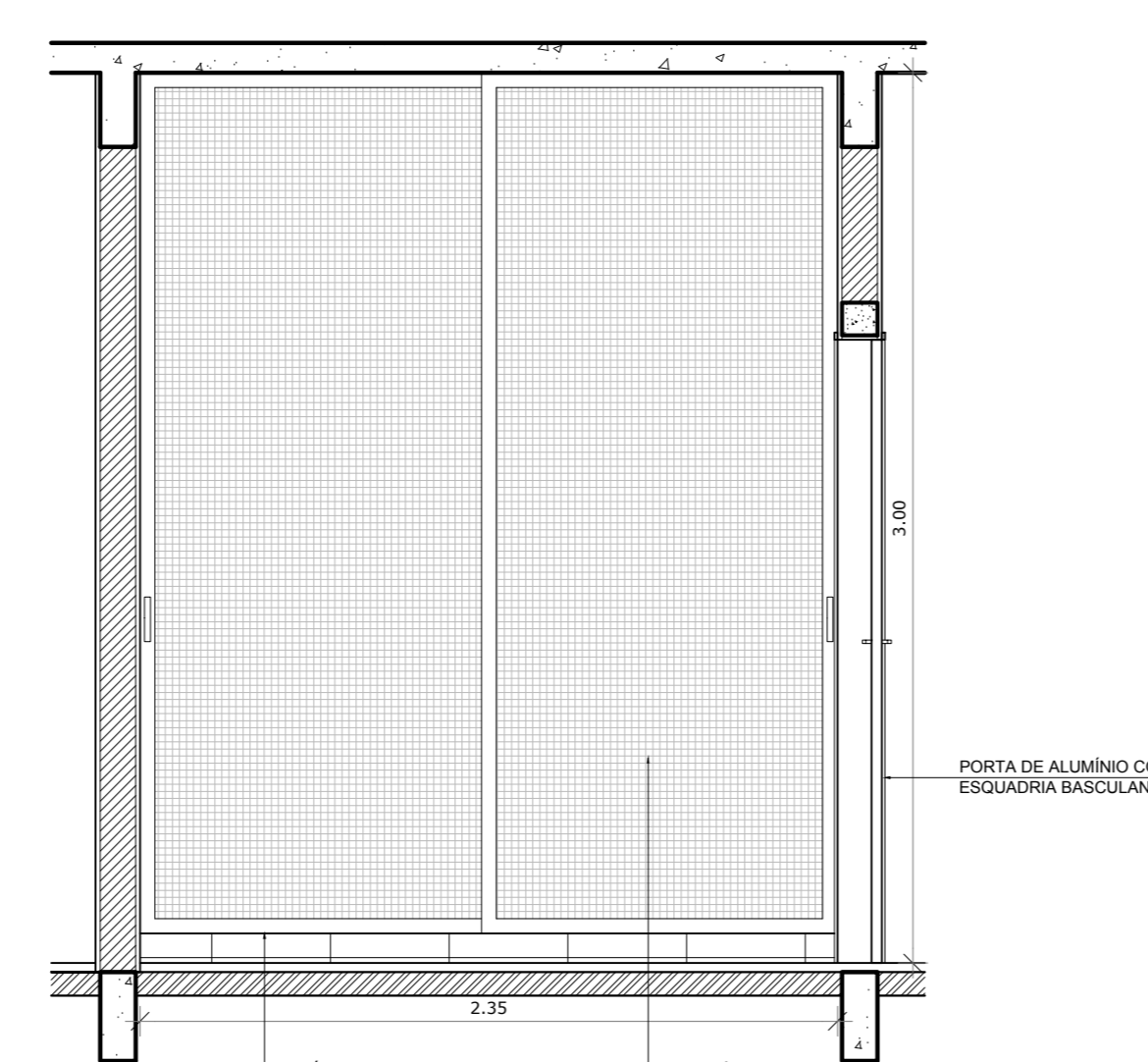

VISTA 4

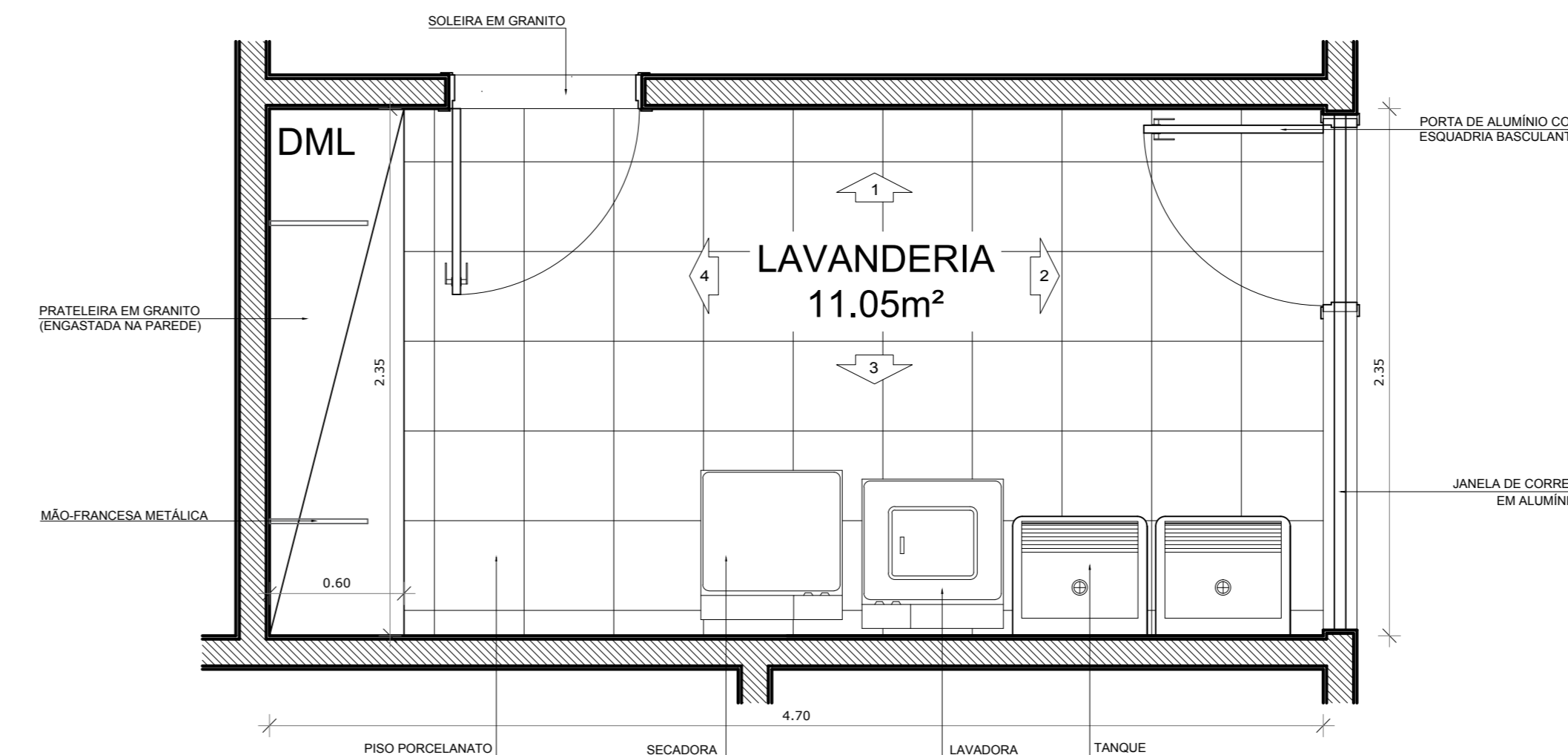

PLANTA BAIXA

REVISÃO	DATA	RESPONSÁVEL	OBSERVAÇÃO

**PREFEITURA MUNICIPAL DE PELOTAS**  
 SECRETARIA MUNICIPAL DA EDUCAÇÃO  
 DEPARTAMENTO DE PLANEJAMENTO E ENGENHARIA

**EMEI IVANIR DIAS**

SECRETÁRIO MUNICIPAL DA EDUCAÇÃO

**PROJETO:**  
 Arquitetônico: Angela C. Bosenbecker  
 CAU - A31414-5  
 RUA GEN. TELLES, 357  
 PELOTAS - RS - CEP 96110-310  
 FONE: 33635522  
 e-mail: angela.bosenbecker@gmail.com

Coordenação do Projeto: Angela C. Bosenbecker  
 CAU - A31414-5

PROJETO:	PROJETO ARQUITETÔNICO	FRANCHA:	PA-11
ENDEREÇO:	R. Manoel Lucas de Lima, 215	LOCAL E DATA:	Pelotas, outubro de 2014.
CONTEÚDO:	Detalhe - Despensa, Cozinha, Casa de gás	ESCALA:	1/25